



Williamthorpe Close, North Wingfield, Chesterfield, Derbyshire S42 5NG

 3  1  2  EPC D

£750 Per Month

PINEWOOD



Williamthorpe Close North Wingfield Chesterfield Derbyshire S42 5NG

£750 Per Month

3 bedrooms
1 bathrooms
2 receptions

- Renovated Three Bed Semi Detached Home - One Double Bedroom - Two Single Bedrooms
 - Modern Fully Tiled Bathroom with White Suite and Shower Over Bath
 - New Decor and New Grey Carpets/Flooring Throughout
 - Modern Kitchen with Integrated Oven, Hob and Extractor
 - Two Reception Rooms
 - Rear Off Road Parking For Two Cars and Rear Enclosed Garden
- Situated In the Heart of the Village of North Wingfield, Within Walking Distance to all the Shop. Schools. Etc
- Gas Central Heating - uPVC Double Glazing - Council Tax Band A - EPC Rated D
- Easy Access to the M1 Motorway Junct 29 and Access to Chesterfield and Clay Cross Towns
- Built in Storage Cupboards to Main Bedroom and Second Reception Room



RENOVATED HOME ...Welcome to this beautifully renovated semi-detached three bed home located on Williamthorpe Close in the charming village of North Wingfield, Chesterfield, Derbyshire. This delightful property boasts three well-proportioned bedrooms, including one spacious double bedroom and two comfortable single bedrooms, making it an ideal choice for families or those seeking extra space.

As you enter, you will be greeted by a bright and inviting atmosphere, enhanced by the new decor and stylish grey carpets and flooring that flow throughout the home. The property features two reception rooms, providing ample space for relaxation and entertaining guests. The modern kitchen is a highlight, equipped with an integrated oven, hob, and extractor, ensuring that cooking is both convenient and enjoyable.

The fully tiled bathroom is another standout feature, complete with a contemporary white suite and a shower over the bath, offering both functionality and style.

Outside, the property benefits from an enclosed rear garden and parking for two vehicles, adding to the convenience of this lovely home, on street parking is also available

Situated in a peaceful area, this semi-detached house is perfect for those looking to enjoy a comfortable lifestyle while being close to local amenities and transport links. This property truly represents a wonderful opportunity to settle in a desirable location. Don't miss your chance to make this house your home.

****VIDEO TOUR AVAILABLE -PLEASE VIEW THIS BEFORE APPLYING****

If you would like to view/apply for this property, please click the 'Request Details' button on Rightmove and enter your information

DISCLAIMER

These particulars do not constitute part or all of a contract. While we endeavour to make our particulars fair, accurate and reliable, they are only a general guide to the property the photos are for reference purpose only, the white goods advertised may not be in situ and and if there are any points which are of particular importance to you or any particular white goods required please check with the office and we will be pleased to check the position on these.



GROUND FLOOR
36.8 sq.m. (396 sq.ft.) approx.

1ST FLOOR
36.7 sq.m. (395 sq.ft.) approx.

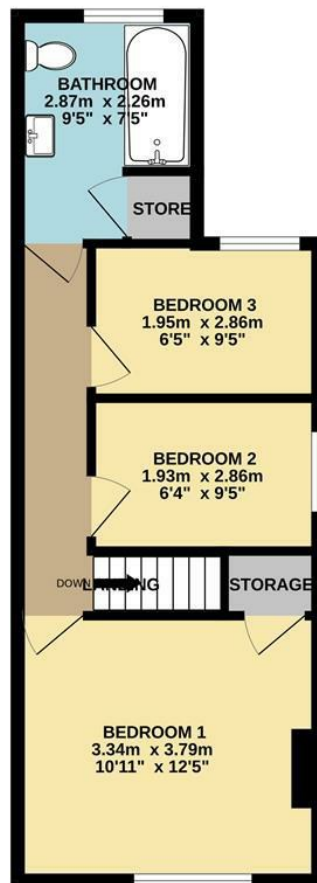
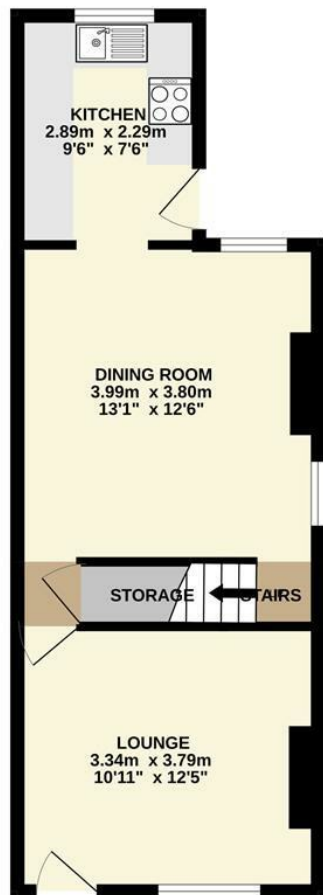

TOTAL FLOOR AREA: 73.4 sq.m. (790 sq.ft.) approx.

Whilst every attempt has been made to ensure the accuracy of the floorplan contained herein, measurements of doors, windows, rooms and any other items are approximate and no responsibility is taken for any error, omission or mis-statement. This plan is for illustrative purposes only and should be used as such by any prospective purchaser. The services, systems and appliances shown have not been tested and no guarantee as to their operability or efficiency can be given.

Made with Metropix ©2026

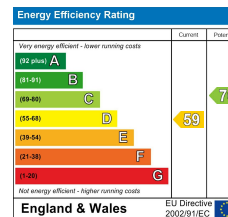

Mansfield branch
24 Albert Street
Mansfield, NG1
01623 621001

Clowne branch
26 Mill Street,
Clowne, S43 4JN
01246 810519

Clay Cross branch
20 Market Street,
Clay Cross, S45 9JE
01246 251194

Chesterfield branch
33 Holywell Street,
Chesterfield, S41 7SA
01246 221039

PINEWOOD

